

1 Hampshire Road Singapore 219428  
www.lta.gov.sg

10 February 2023

Our ref LTA/CP(NW)/C37.040.001/0000393

Owner and Occupier

Dear Sir/Madam

**Traffic Realignment Plan and Trees Removal at Centre Median along Dairy Farm Road**

1. The Land Transport Authority's appointed contractor, M/S Hwa Seng Builder Pte Ltd, will be carrying out the construction and realignment of the centre median along Dairy Farm Road. This road widening is necessary to cater to the projected increase in traffic in the vicinity.
2. Our approach of trying to minimise the impact of our projects on greenery, and to take mitigating measures where it cannot be avoided is applied to all of LTA's transport infrastructure projects. It reflects our commitment to improving transport accessibility for motorists in a sustainable manner.
3. However, after careful and detailed planning, the trees (Eugenia) located at the existing centre median of Dairy Farm Road (refer to **Annex A** for location map) have been identified to be within the footprint of the proposed road widening area. We have explored all other possibilities, but we are unable to keep the trees. They have also been assessed to be unsuitable for transplanting and will be removed from **June 2023 onwards**.
4. We are working closely with NParks to progressively plant the new centre median with a mixture of Eugenia and Rain trees before the removal works. Our contractors will implement the necessary mitigating measures to minimize any inconveniences to the residents and stakeholders. Direction and information signs will be displayed in advance to inform and guide the residents and motorists. All road users are advised to be cautious when approaching our work area.
5. Please feel free to contact the following personnel should you have any queries:

**Hwa Seng Builder Pte Ltd**

Ms Ang Shu Yi, Public Relations Officer

Mobile: 9623 3378

Email: [DE113@hwaseng.com.sg](mailto:DE113@hwaseng.com.sg)

Telegram:



6. We seek your patience and understanding as we work towards the completion of this project.

Yours sincerely,



Alex Ong  
Manager, Community Partnership, (North-West)  
QSMO, Community and Customer Engagement Group

**Annex A**

**Location Map of Stage 1 Traffic Diversion (Towards Upper Bukit Timah Road)**

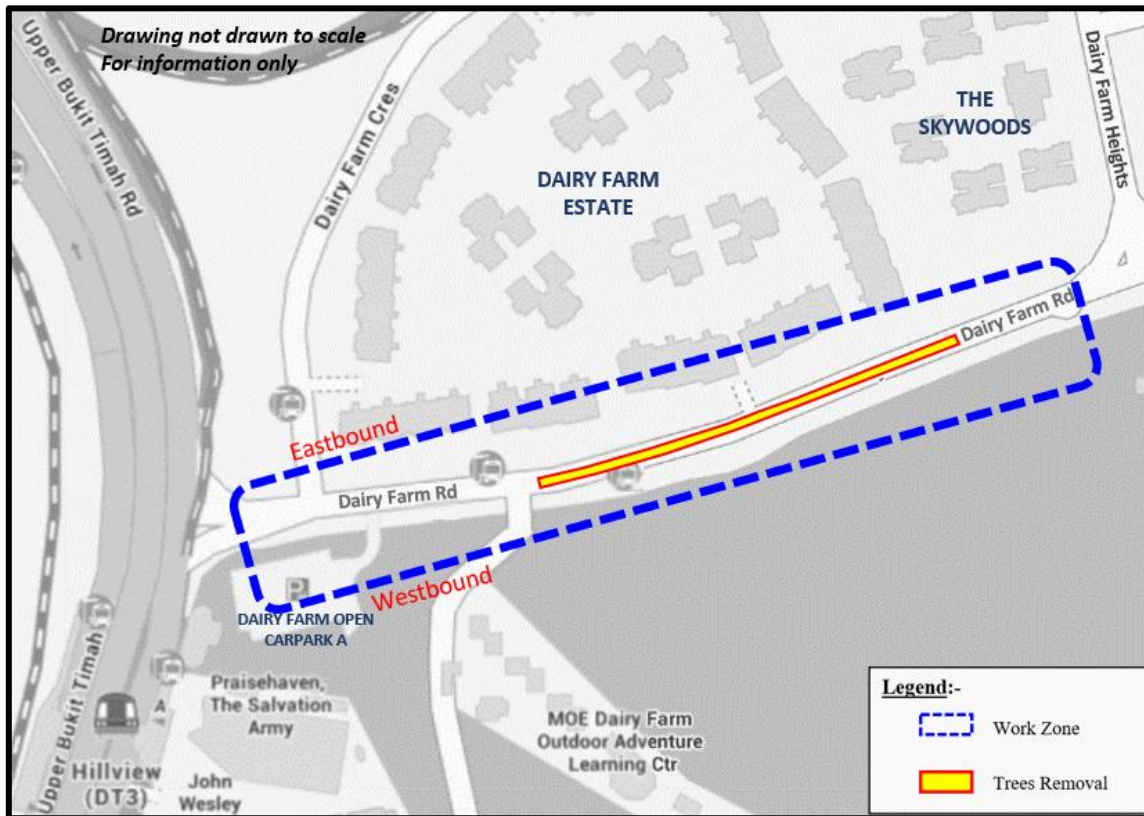

**Affected Trees along Centre Median of Dairy Farm Road**

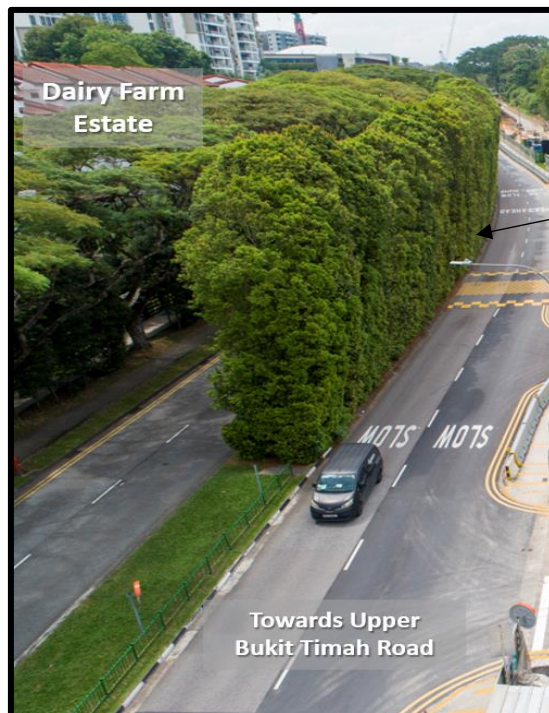

Row of affected trees along existing centre median