

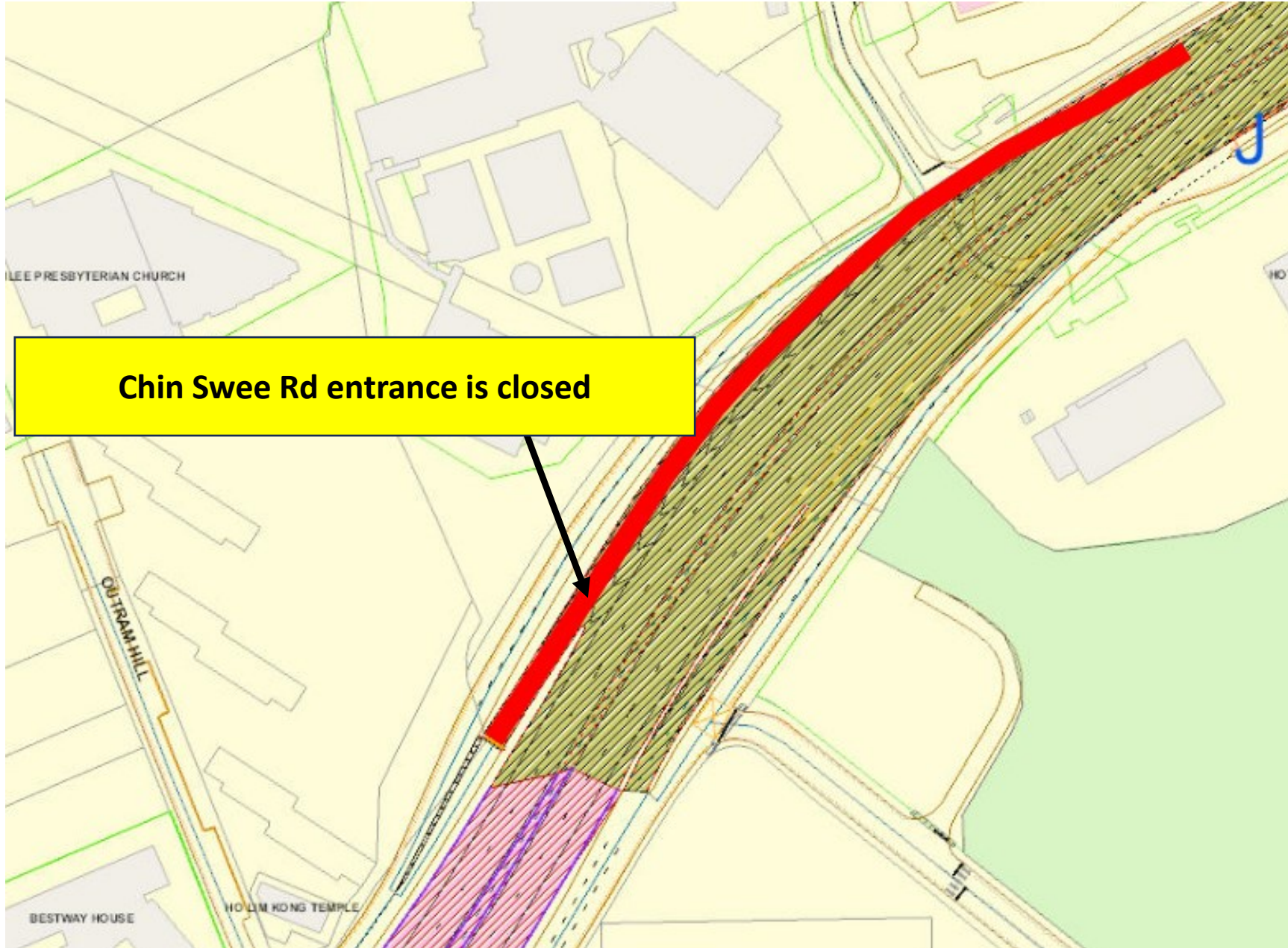



2 February 2024, 5 February 2024 and 6 February 2024
12.00am to 05.00am



Legend

-  Route closed
-  CTE
-  Tunnel

7 February 2024
12.00am to 05.00am

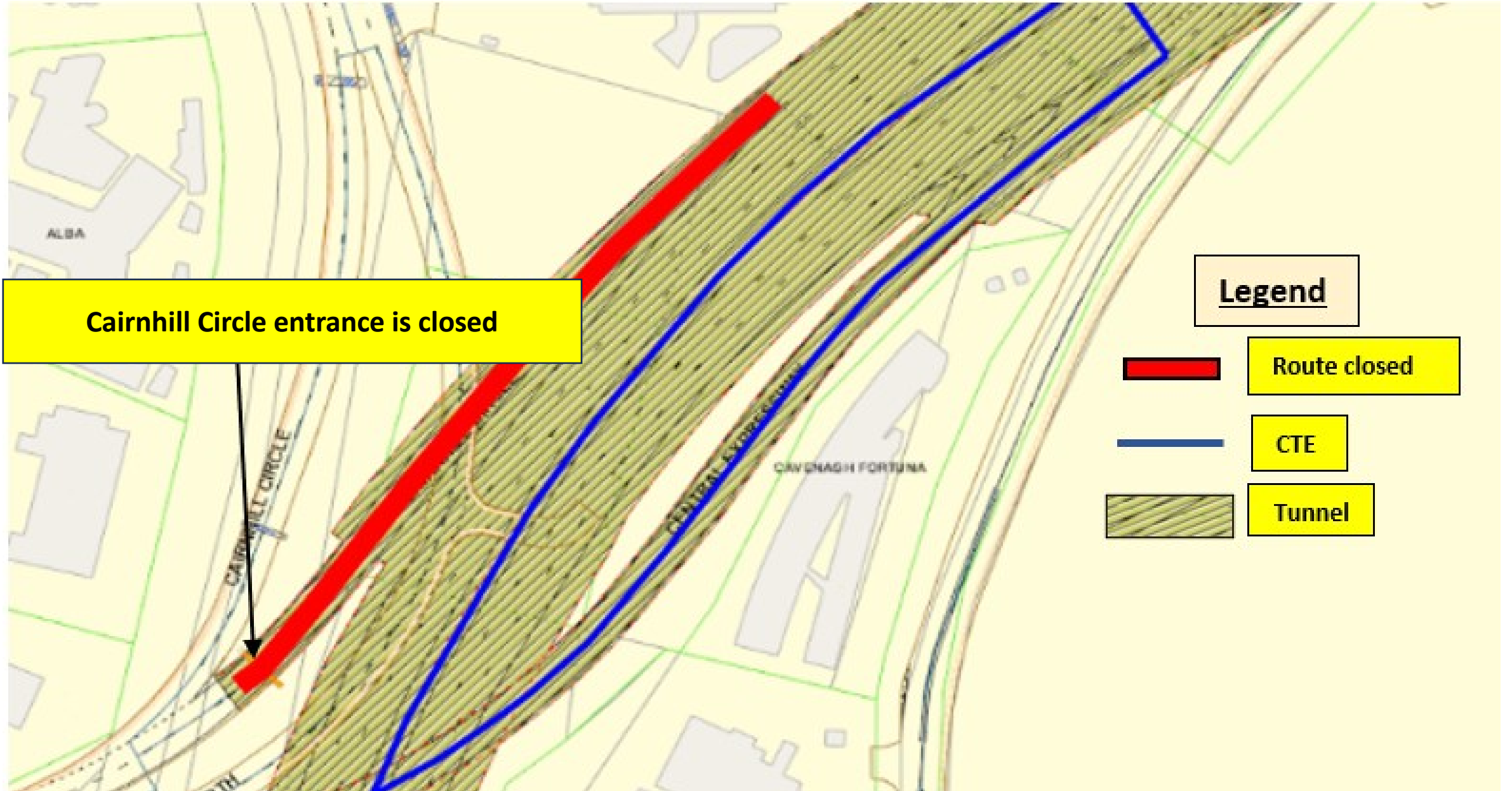

19 February 2024 to 22 February 2024
12.00am to 05.00am



22 February 2024, 23 February 2024 and 1 March 2024

12.00am to 05.00am

