

Steps to register your Phone's Bluetooth MAC Address

Step 1: Get ready your Phone's Bluetooth MAC Address for registration.	Step 2: Login to OneMotoring Digital Services - https://erp.lta.gov.sg/internet-esv	Step 3: Tap on "Manage On-Board Unit (OBU)".
<p>Steps* to find your Phone MAC Address:</p> <ul style="list-style-type: none"> • Open "Settings". • Tap "System". (Skip this step on some models) • Tap "About Phone" or "About device" • Tap "Status". • Bluetooth Address will be shown in the list. • Copy Bluetooth Address <p>*Actual steps may differ slightly depending on the phone model and version used.</p>		

Step 4: Tap on “+” of the OBU that you like to pair with your phone.

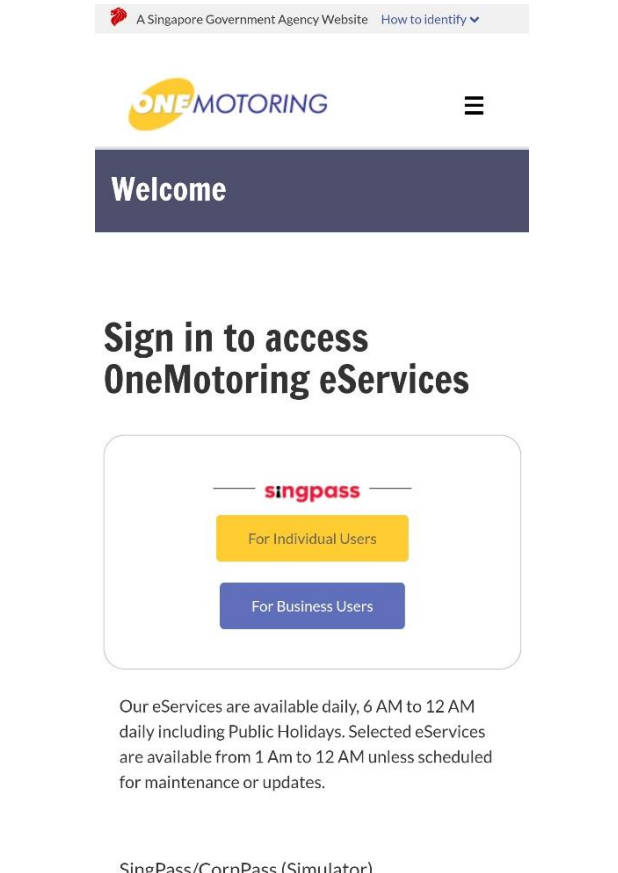
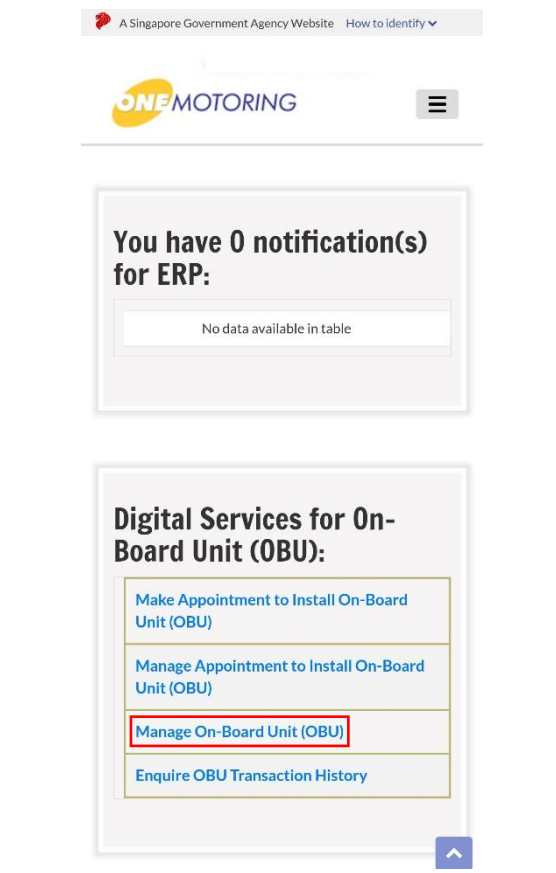
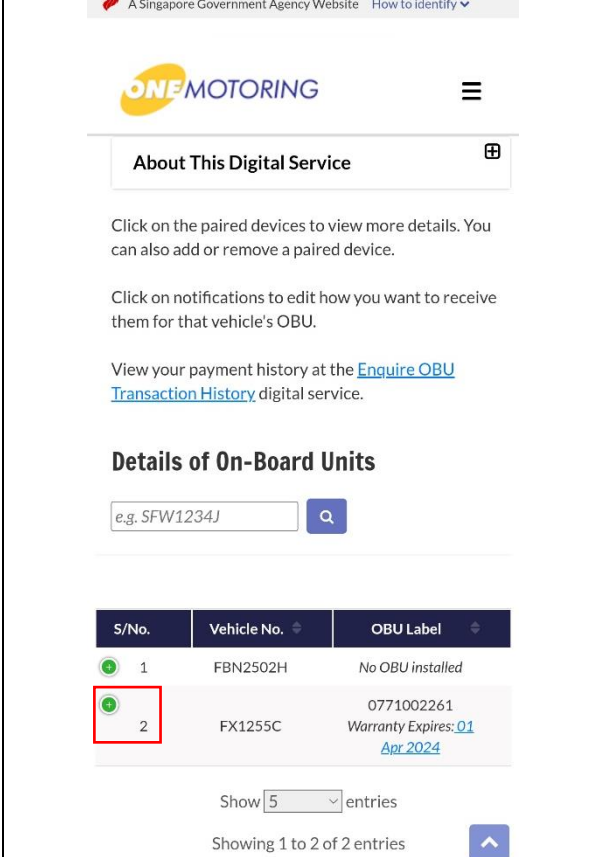

Step 5: Tap on “No” under Paired Devices.

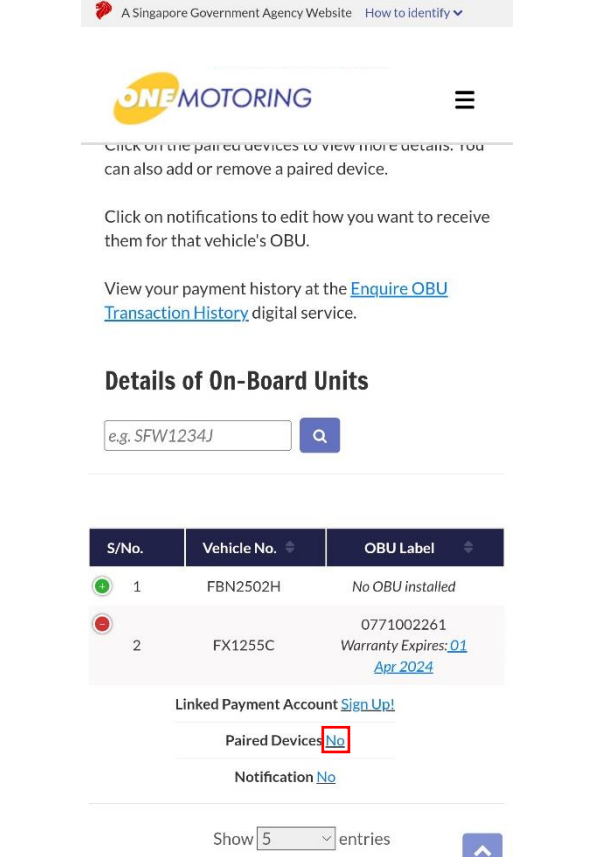

Step 6: Tap on “Pair New Device”.



Step 7: Enter Device name and MAC Address and "Next".

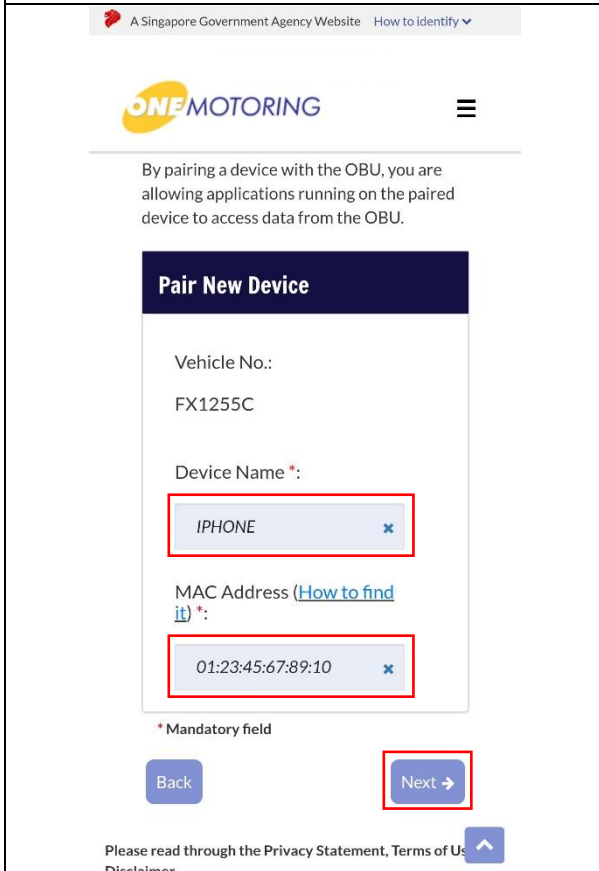

Step 8: Tap "Ok".

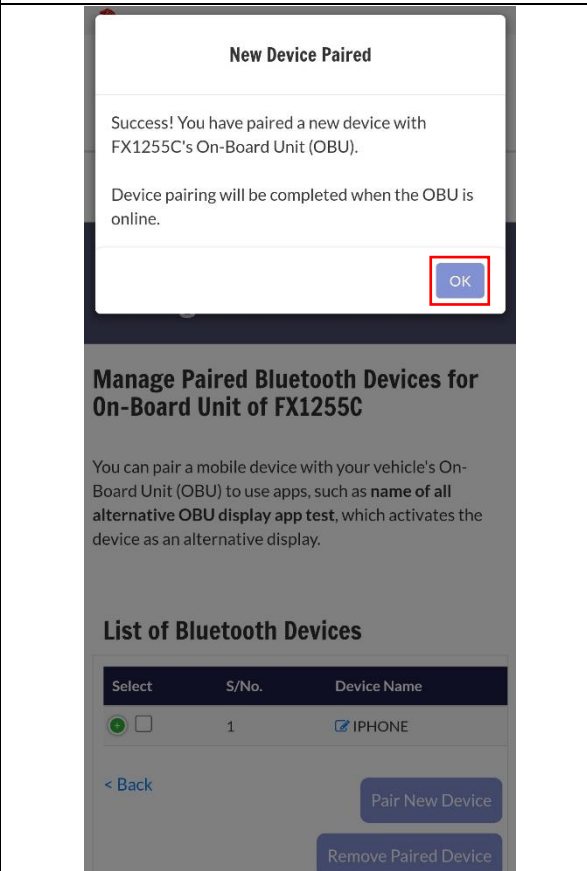

Step 9: You can add another Device or Remove added Device.

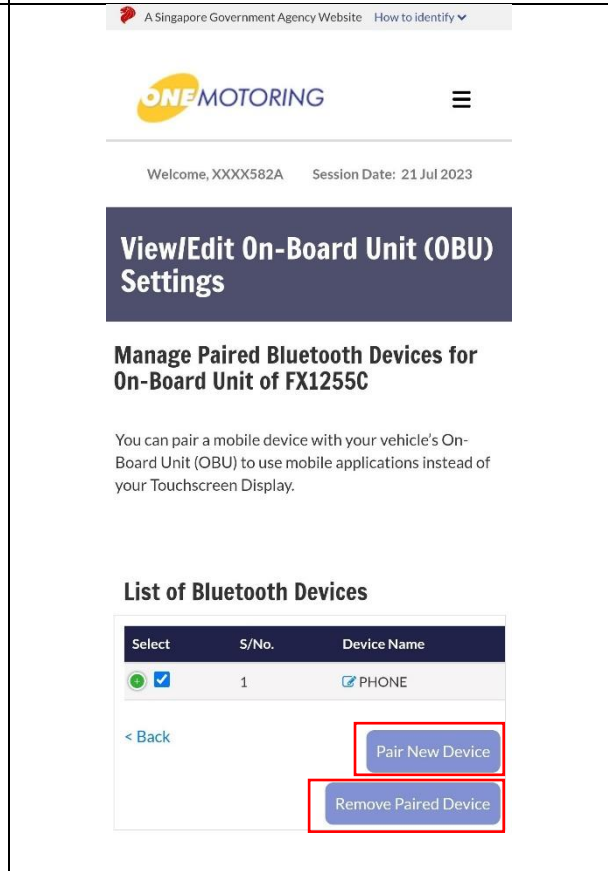

Steps to pair your Phone with OBU using ERP 2.0 Mobile Application



1. Launch "ERP 2.0" mobile application

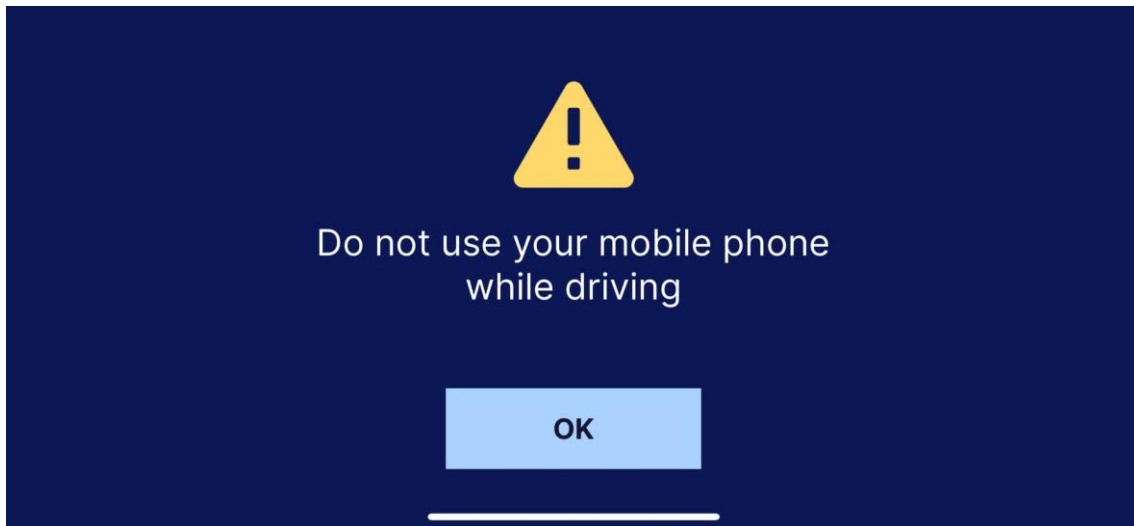

2. Acknowledge Cautious message while driving

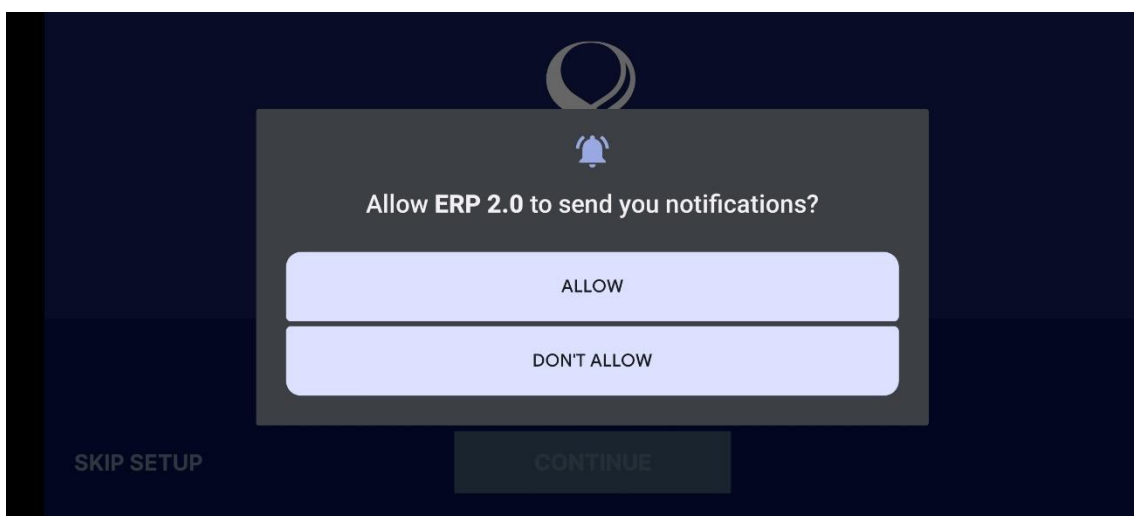

3. Allow "ERP 2.0" to send you Notifications

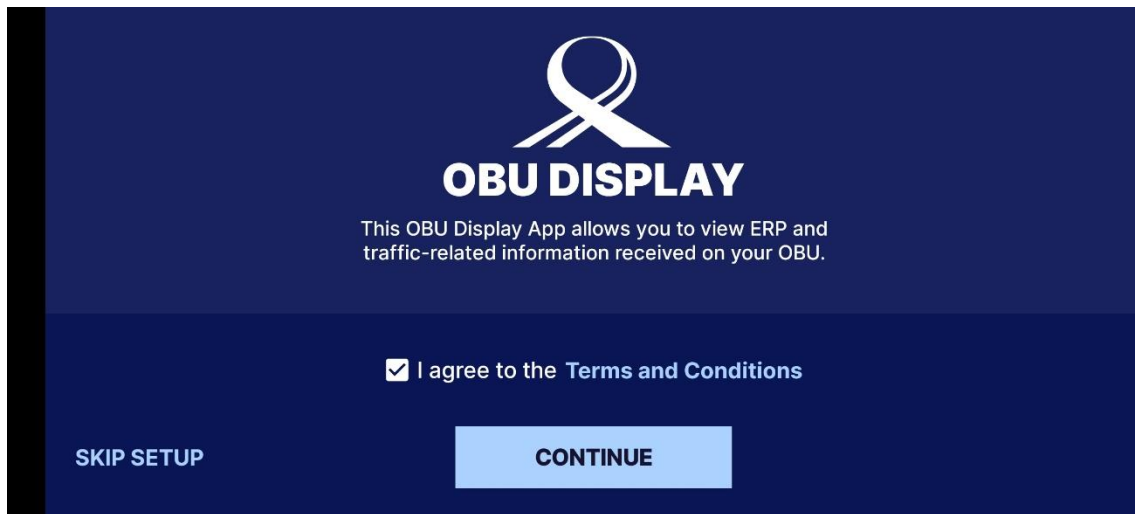

4. Agree to the Terms and Conditions to continue



5. Allow "ERP 2.0" to access your OBU data

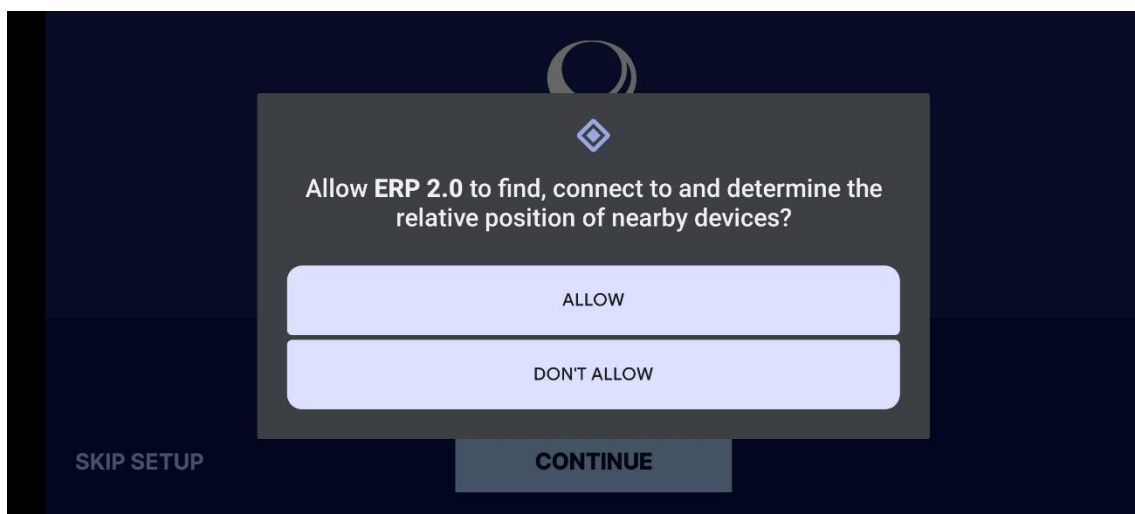

6. Allow "ERP 2.0" to search for your OBU

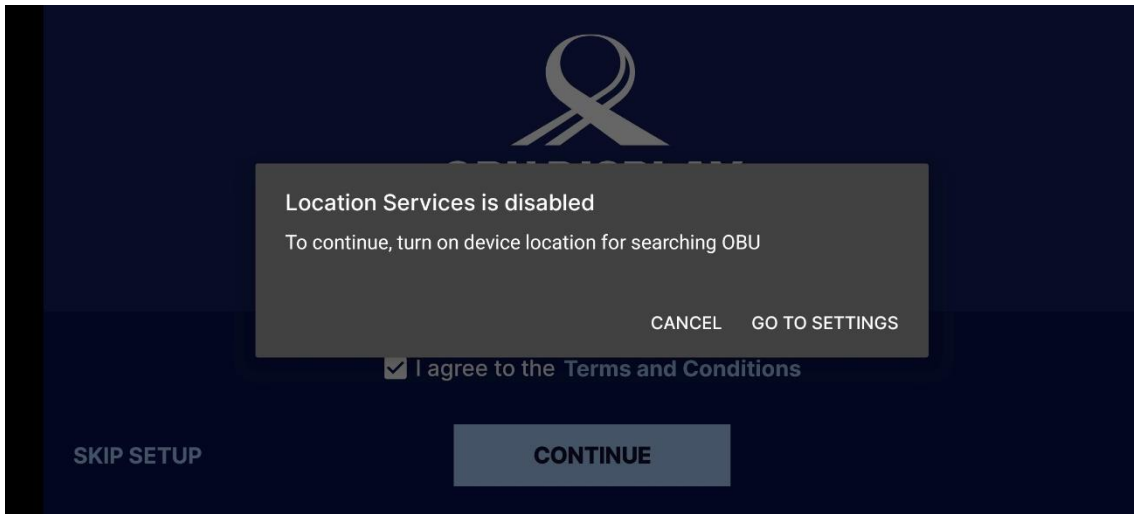

7. Turn on your device location to search for your OBU

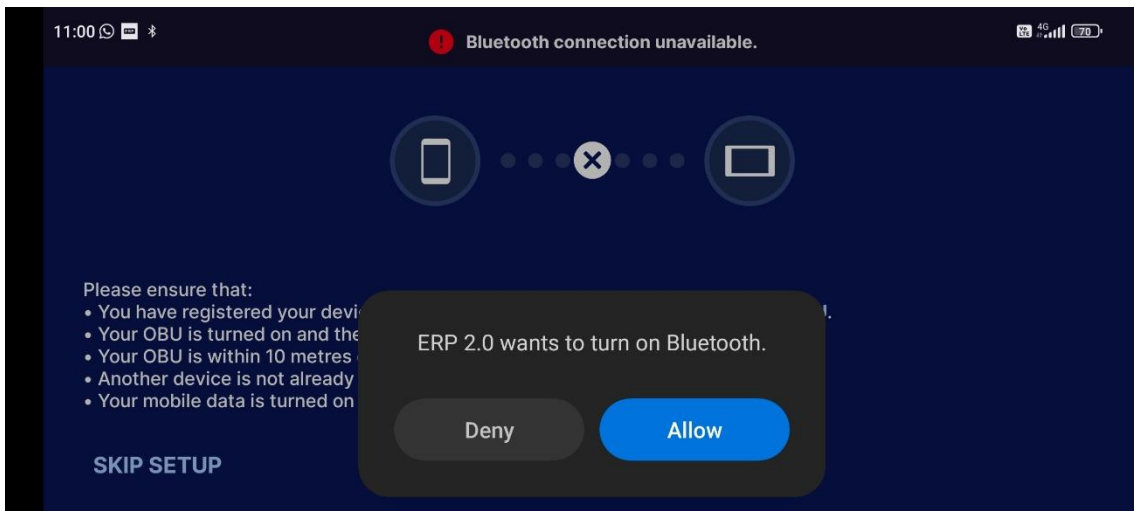

8. Allow "ERP 2.0" to turn on Bluetooth to search for your OBU

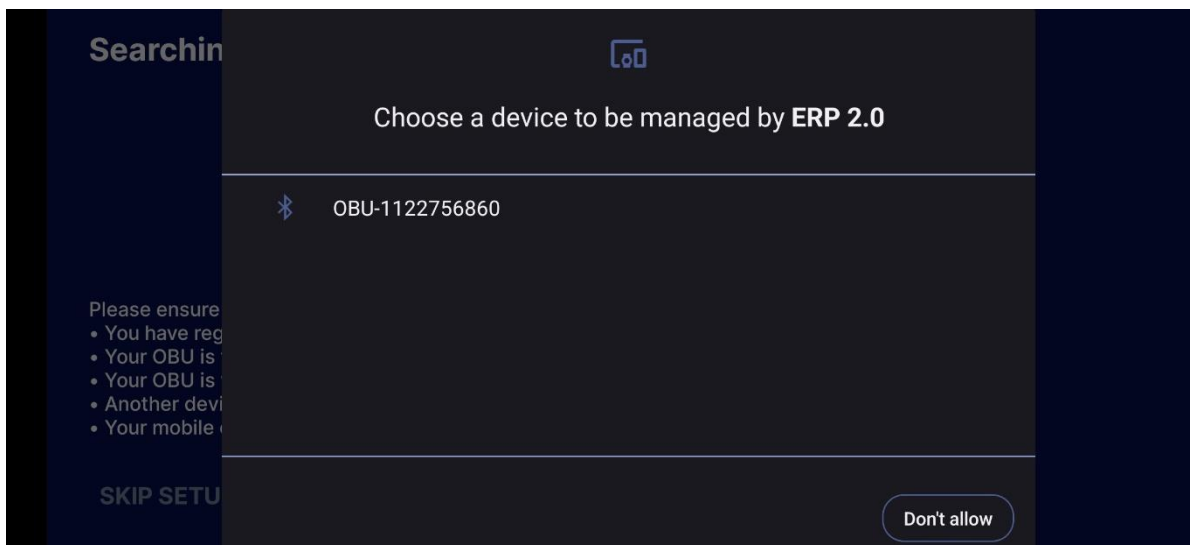

9. Tap on your OBU to pair

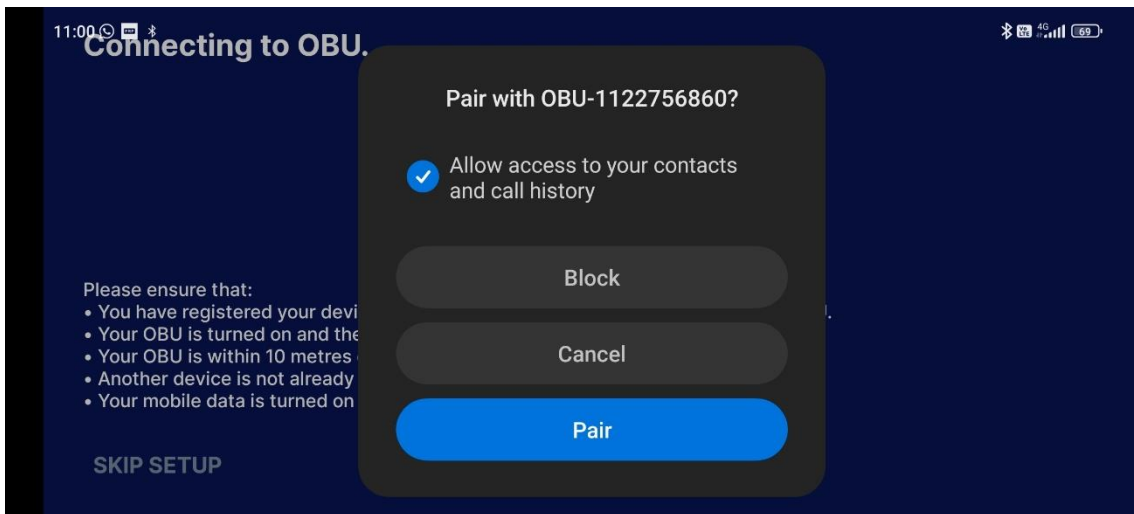

10. Tap "Pair" to pair with your OBU

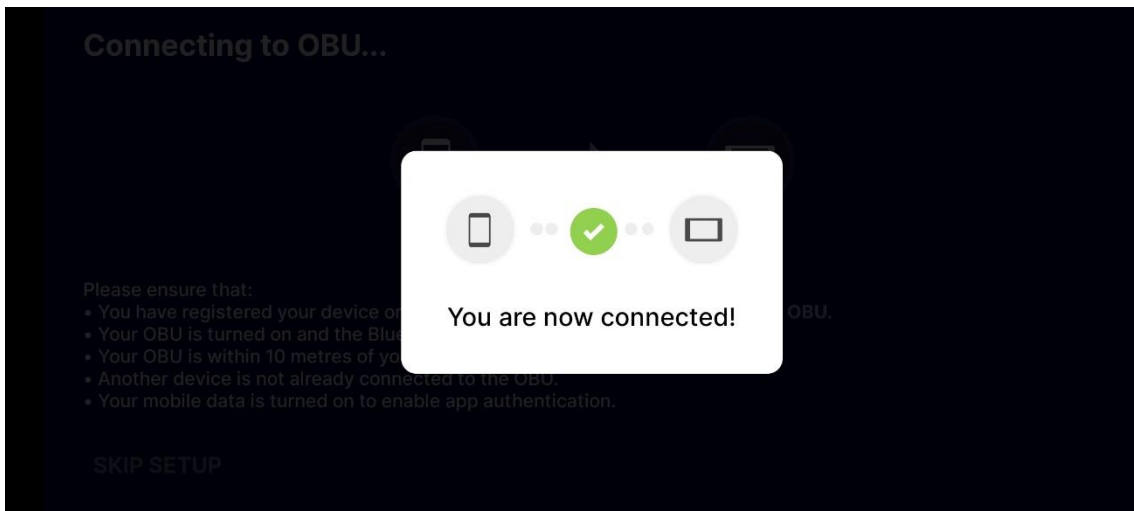

11. Your Phone and OBU had connected successfully

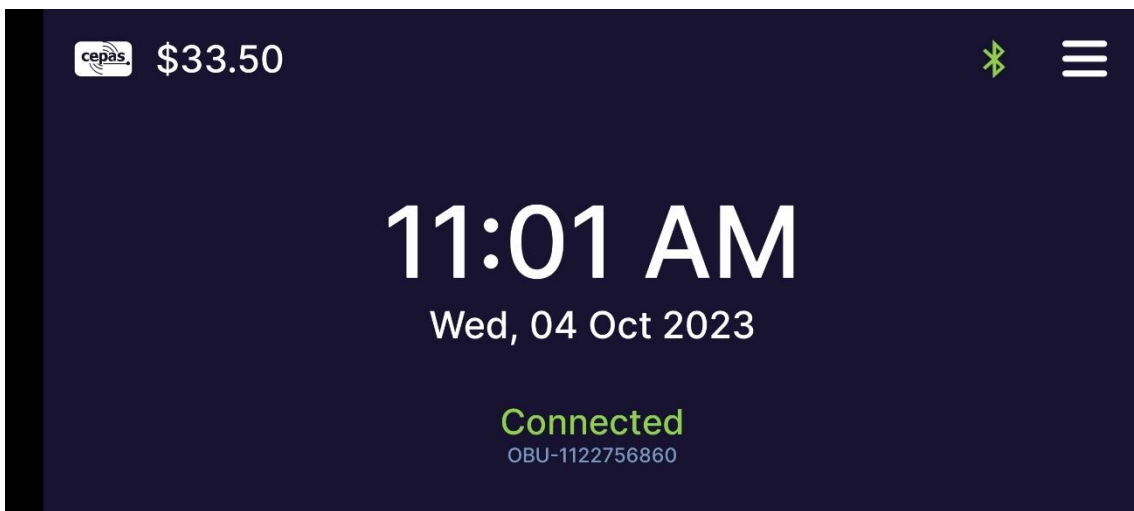

12. Ready to use